

手滑阀 / Hand Valve

型号注释 / Note for type:

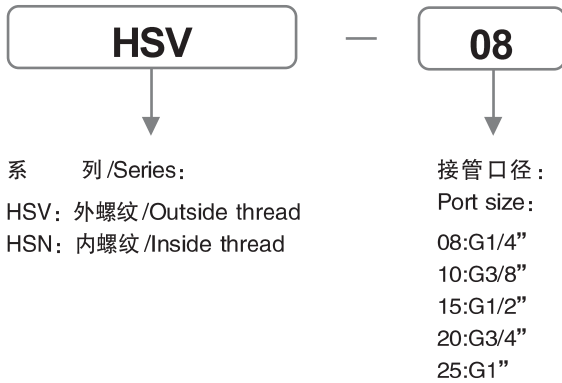

技术参数 / Specification:

型 号 / Type	HSV, HSN-06	HSV, HSN-08	HSV, HSN-10	HSV, HSN-15	HSV, HSN-20	HSV, HSN-25
接管口径 / Port size (G)	1/8"	1/4"	3/8"	1/2"	3/4"	1"
工作介质 / Fluid	经 40 μ m 过滤的压缩空气 / Compressed Air					
工作压力 / Operation pressure (MPa)	0.2-0.8					
使用温度范围 / Ambient temperature (°C)	-5-60					

外形尺寸 / Dimension(mm):

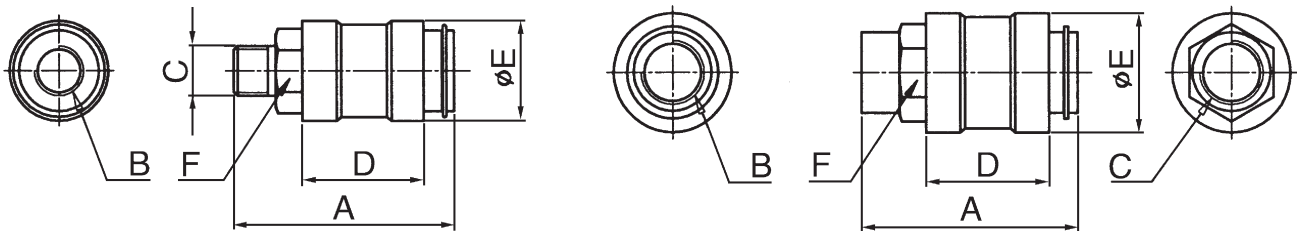

符号 / symbol	A	B	C	D	E	F
型号 / type						
HSV、HSN-06	58	G1/8"	G1/8"	32	26	19
HSV、HSN-08	58	G1/4"	G1/4"	32	26	19
HSV、HSN-10	57	G3/8"	G3/8"	32.5	31	22
HSV、HSN-15	92	G1/2"	G1/2"	49	38.5	27
HSV、HSN-20	112	G3/4"	G3/4"	62	52	36
HSV、HSN-25	120	G1"	G1"	65	58.5	42